

TRUCKOSAUR

THE ULTIMATE TRANSFORMATION

Please read the instructions carefully.
Truckosaur is for children 6+.
Not suitable for children under 36 months.
Should be operated with adult supervision.
Please Keep the instruction manual for future reference.

Instruction Manual

Contents

Truckosaur



Infrared Controller

Features

- Infrared Controlled
- Dual mode: Transformation from a Heavy- Truck to a Tyrannosaurus and vice versa
- Two Playing Modes: Truck and Tyrannosaurus
- Truck mode: Moves Forwards, Backwards, turns Left and Right, & with Truck Horn
- Tyrannosaurus mode: Walking Forwards, turns Left and Right, & with Tyrannosaurus Roars
- Control Distance: 20 ft (6m)

9V Battery Requirements

- 6 x size "AA" LR6 1.5V battery for Truckosaur.
- 1 x size "9V" 6LR61 battery for infrared controller.

(Note: For the best performance and longer play time, ALKALINE batteries are recommended. Batteries are not included in this package.)

BATTERY CONTACTS
Bent or dirty battery contacts may result in loss of power.

Preparations

Your Truckosaur comes completely assembled. All you need to do is to insert batteries into the controller unit and the "battery compartment" in the bottom of Truck.

Battery Installation of Truckosaur

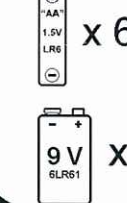

• Make sure new batteries are being used.

• Make sure the Truckosaur power switch is in "OFF" position before installing batteries.

- Replace the "battery compartment" and battery cover to the Truckosaur.
- Insert 6 size "AA" LR6 1.5V batteries into the "battery compartment". Make sure the polarity of the batteries following the polarity marking shown on the battery compartment.
- Take out the entire "battery compartment".
- Remove the battery cover of the "battery compartment" located in the bottom of the Truckosaur.

Battery Installation of Infrared Controller

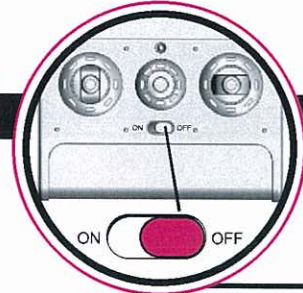

• Make sure the controller power switch is in "OFF" position before installing batteries.

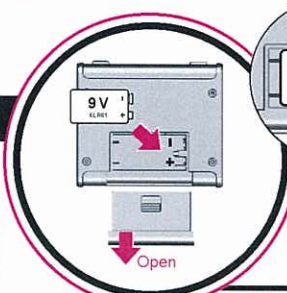

• Remove the battery cover from the back of the controller and insert a size "9V" 6LR61 battery following the polarity markings on the battery compartment.

Replace the battery cover.

Caution

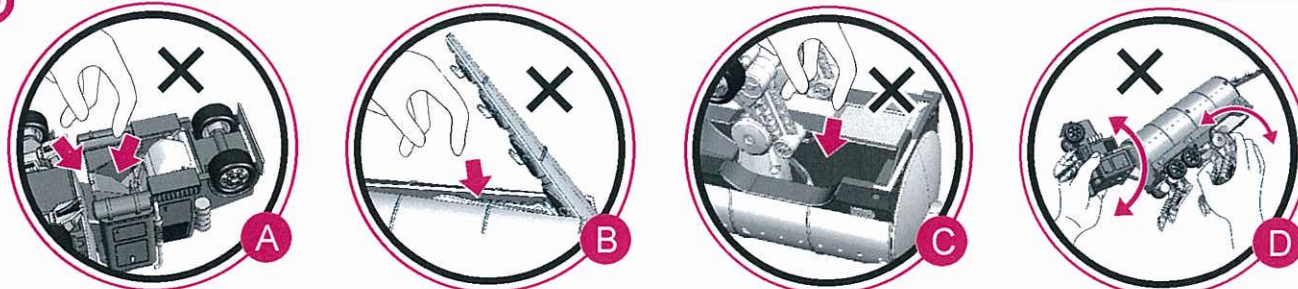

- This toy is not intended for children under 3 years old.
- Remove all packaging material before the toy is given to a child.
- Adult supervision is recommended when Truckosaur is being operated.
- Do not play Truckosaur near water, roads and stairs as there is a potential hazard and it will cause damage to the Truckosaur.
- Keep fingers, hair and loose clothing away from the wheels and joints to prevent entanglement and entrapment.
- Never put your hands, fingers or any objects into the gap, it will create the risk of unexpected injury or causing damage to the Truckosaur. (Diagram 'A', B and C)
- Do not bend any joints of the Truckosaur by your hand such as the tail, claws/legs and head as this may affect its performance or even hurt you. (Diagram 'D')
- Do not put any objects or tie materials around the moving joints such as the head, tail and claws/ legs of Truckosaur, as it will cause damage to the Truckosaur.
- Do not pick up Truckosaur while it's in motion.
- Do not hold the wheel while Truckosaur is moving or going to move as it may hurt your finger.
- Do not pick up the Truckosaur by holding its head, claws or legs only, as it may break the Truckosaur or affect its function.
- Never disassemble or attempt to modify the Truckosaur. It may damage the Truckosaur and cause danger.
- Do not expose the Truckosaur and the controller to water. If those are being exposed to water accidentally, remove the batteries and allow them to air-dry. Replace with a new battery before resuming operation.
- Always switch OFF the power when Truckosaur is unattended or not in play.
- If you are not going to play with Truckosaur in a short period of time, remove the batteries. Never leave weak or dead batteries in the Truckosaur and/or controller, as they may leak damaging chemicals.

Helpful Tips

- To ensure proper performance, Truckosaur is not recommended to be used on deep pile carpets, soft surfaces or sandy ground. A hard, bare, flat, and level surface is recommended.
- The Truckosaur is intended for indoor use only. It cannot work under sunlight or a blaze of light.
- Make sure the rear (motive) wheels contact with the floor for driving.
- There may be some "clicking" sound during transformation. It is normal and it will frequently occur when the battery is nearly exhausted. It is time to replace the battery in such case.
- The tail of Truckosaur is detachable. If there is a hard drop or crash to the tail, it can be detached and you can simply insert it back.
- Do not transform the Truckosaur manually by bending its legs, claws, tail and head in purpose as this will affect its performance or cause damage.
- If you find the Truckosaur drives hardly, there may be dusts entangling in the wheel. You should clean up the wheel for having a smoothly drive.
- Do not use a damp cloth or immerse the Truckosaur into water for cleansing; only use a dry cloth to clean.
- Point your transmitter of controller directly to the infrared receiver of Trucksaur for better control.
- If your Truckosaur gets too far away, it will not work properly.
- When the Truckosaur starts to lose power, it may lose functions or performance. It's time for refresh the batteries. Your Truckosaur running time may vary depending on your driving style.
- Please note the controlling distance may be varied depending on the playing environment since the infrared signal is affected by lots of obstacles.
- Do not store the Truckosaur or controller near heat or in direct sunlight.

Battery Caution

Batteries may leak damaging fluids that can cause a chemical burn injury or ruin your toy. To avoid battery leakage:

- Always follow the instructions carefully.
- Do not mix old and new batteries or batteries of different types.
- Do not mix alkaline, standard (carbon-zinc) or rechargeable (nickel- cadmium) batteries.
- Use only batteries specified and insert it correctly by the + and - polarity markings.
- Always follow the toy and battery manufacturer's instruction.
- Remove batteries when not in use. Always remove exhausted batteries from Truckosaur and controller. Dispose batteries safely.
- Non-rechargeable batteries are not to be recharged.
- Battery installation should be done by an adult.
- Never short-circuit the battery terminals.
- Dispose of old batteries promptly and properly; do not burn or bury them.
- Do not dispose of batteries in a fire, batteries may explode or leak.
- Do not disassemble a battery as it may burst and release toxic liquids.
- Bent or dirty battery contacts may result in loss of power.
- Rechargeable batteries are only to be charged under adult supervision.

Troubleshooting Guide

If you are experiencing difficulties in playing Truckosaur, besides calling our customer service hotline, please try to use below suggested solutions:

Problems	Solutions
1 Truckosaur is not responding to the controller.	a) The control distance is too far. Control the Truckosaur less than 6m. Or b) The obstacles between the controller and the Truckosaur could influence the controlling signals. Point the transmitter of controller directly to the infrared receiver of Trucksaur for better control. Or c) The Truckosaur is designed for indoor operation only. Do not play the Truckosaur under sunlight or a blaze of light. Or d) The battery of the controller/ Truckosaur is exhausted. Replace new batteries to the controller.
2 Truckosaur does not move properly.	a) The legs of Truckosaur maybe unbalance after some abnormal play so the wheels cannot contact the floor well. Adjust the legs to contact the ground consistently. Or b) Truckosaur is not suitable to play on deep pile carpets, soft surfaces or sandy ground. Try to play it on a hard, bare, flat, and level surface. Or c) There maybe dusts or obstacle to entangle the wheel. Check it out and remove it.
3 Truckosaur does not transform properly.	a) The legs of Truckosaur maybe unbalance after some abnormal play so the wheels cannot contact the floor well. Adjust the legs to contact the ground consistently. Or b) The battery of Truckosaur is nearly exhausted. Replace it with new batteries.



Waste electrical products/batteries should not be disposed of with household waste. Separate disposal facilities exist, for your nearest facilities.

If there is any problem with Truckosaur, please call our Customer Service Hotline: (852) 2793 1288.
Please try not to return goods to retail stores directly. For Enquiry: info@aok-ltd.com

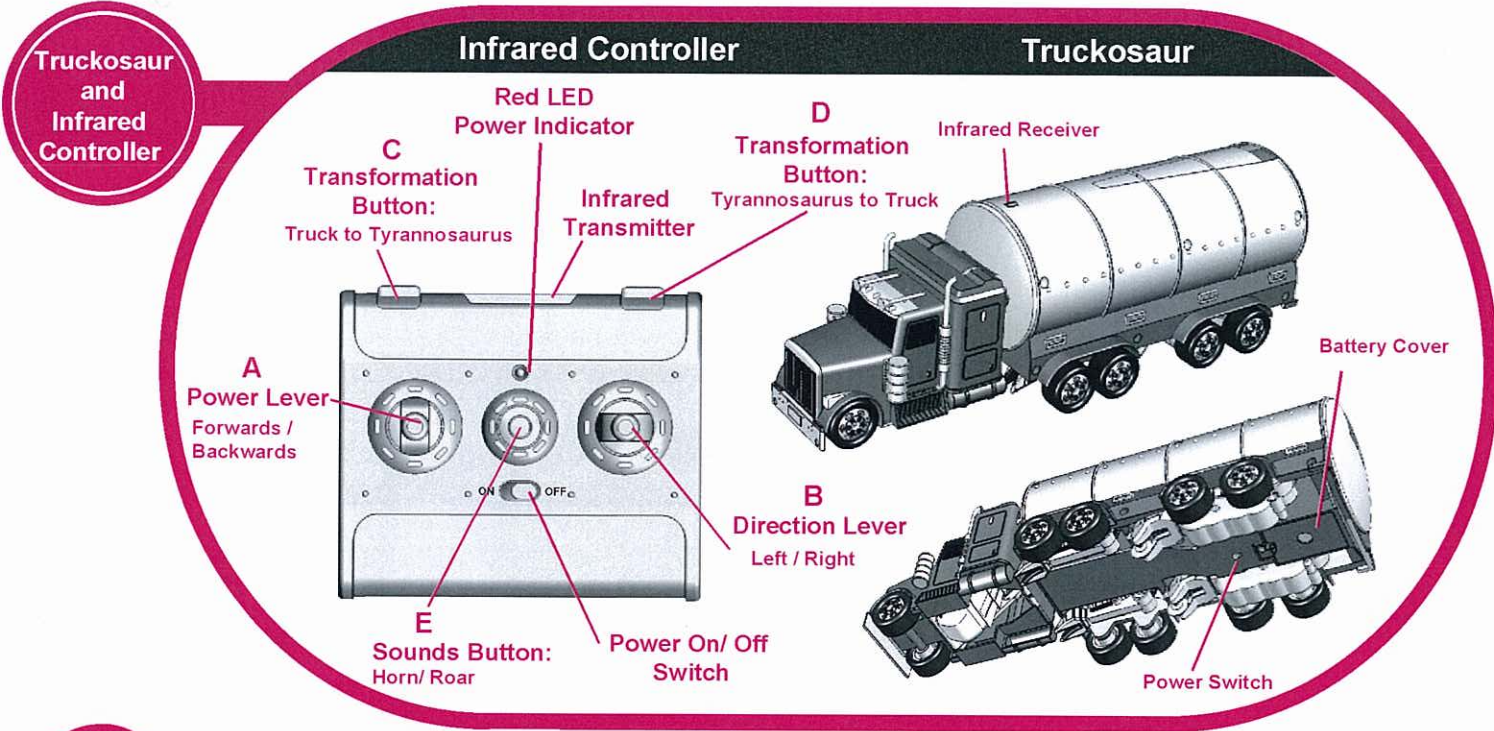

How to Operate Truckosaur

Starting Up

Set the Truckosaur power switch to the "ON" position.

Turn on the Truckosaur controller.

Use the controller's levers to control the movements and directions of Truckosaur as well as to transform it.

Truck Mode Start Playing

Movements

Forwards
Push lever "A" up, the Truck will go forwards.

Backwards
Push lever "A" down, the Truck will go backwards.

Left Turn
Push lever "A" up while pushing lever "B" to the Left to make the Truck turn left.

Right Turn
Push lever "A" up while pushing lever "B" to the Right to make the Truck turn right.

Sound: Truck Horn
Pressing the sounds button "E" once to hear the truck horn.

Transforms From Truck to Tyrannosaurus
Pressing the button "C" once to Transform from Truck to Tyrannosaurus automatically.

Tyrannosaurus mode

Movements

Walk Forwards
Push the lever "A" up, the Tyrannosaurus will walk forwards.

Left Turn
Push lever "A" up while pushing lever "B" to the Left to make the Tyrannosaurus turn left along with walking.

Right Turn
Push lever "A" up while pushing lever "B" to the Right to make the Tyrannosaurus turn right along with walking.

Sound: Tyrannosaurus Roar
Pressing the sounds button "E" once to hear the Tyrannosaurus roar.

Transforms From Tyrannosaurus to Truck
Pressing the button "D" once to Transform from Truck to Tyrannosaurus automatically.

* The Sounds are being set according to the playing mode. When it is in "Truck Mode", you will only hear the "Truck Horns". When it is in "Tyrannosaurus Mode", you will only hear the "Tyrannosaurus Roars".